

# Tableau File Types

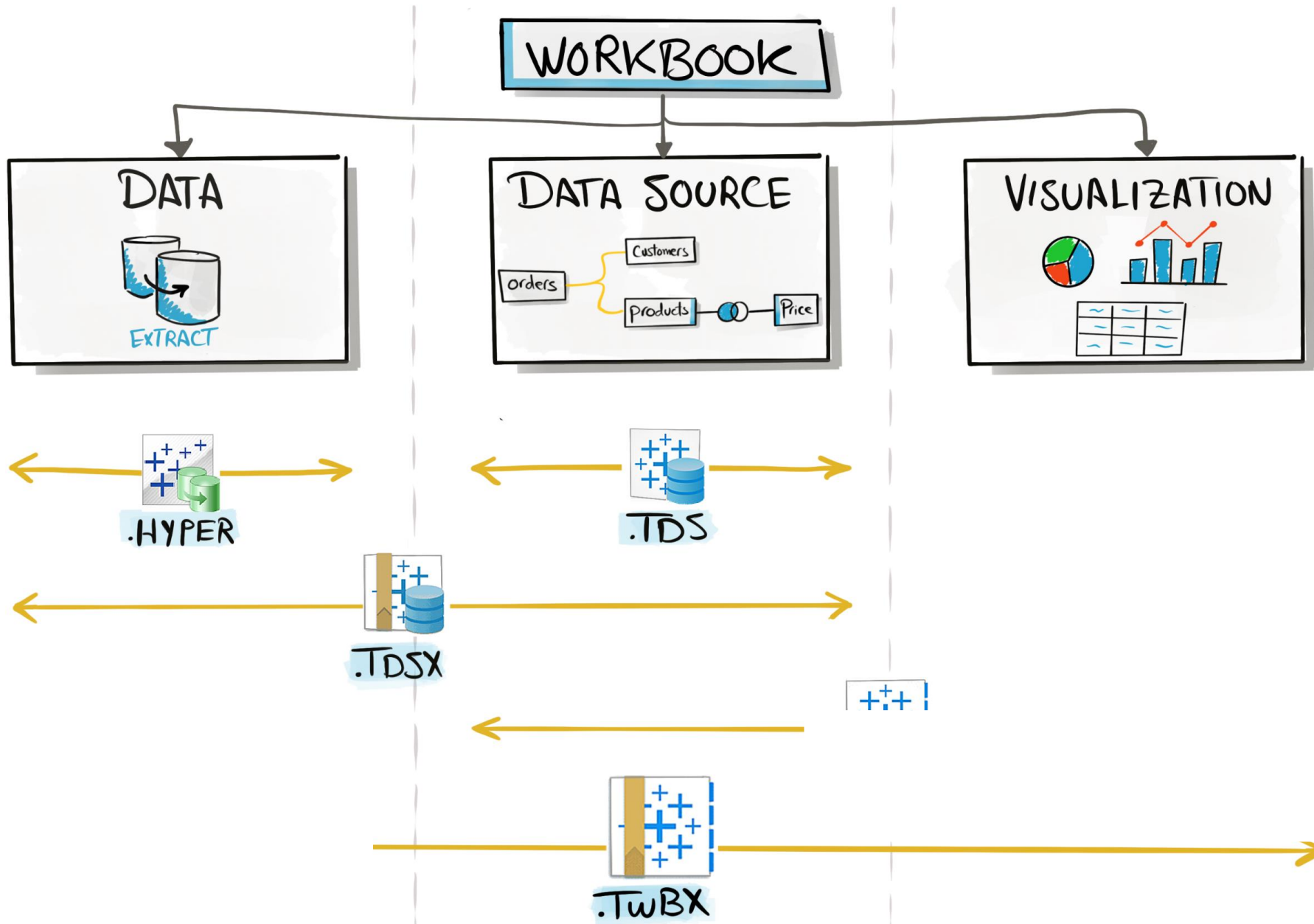

With Data



	tableau Desktop	tableau Reader	tableau Public
.HYPER	✓	✗	✗
.TDSX	✓	✗	✗
.TWBX	✓	✓	✓

Without Data

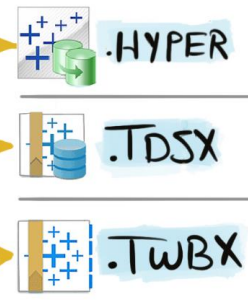
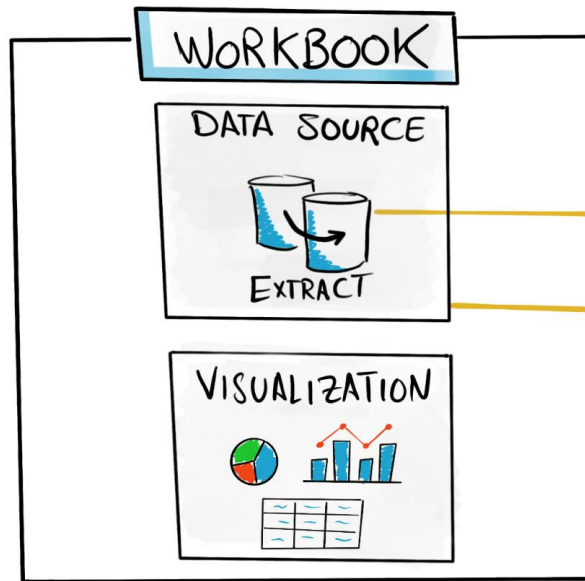
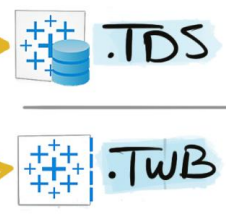
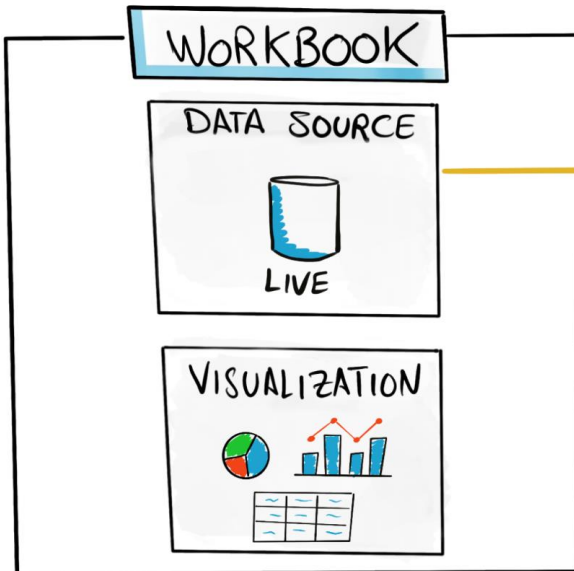

.TDS	✓	✗	✗
.TWB	✓	✗	✗

## DATA CONNECTORS

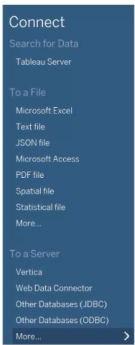

90 CONNECTORS

## CONNECTION TYPE

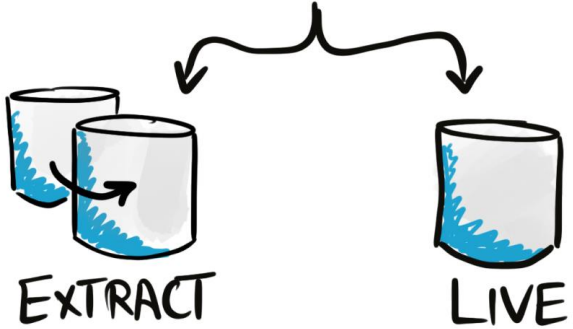

## ACCESS INFO

*Path* → E:\User\Data\Tableau\sales.csv

*DB Location* → Server: localhost Port: 3306 Database: myfirstwebsitedb

*Access token* → czZCaGRSa3F0MzpnIUjK09lqErXJW

## DATA MODEL

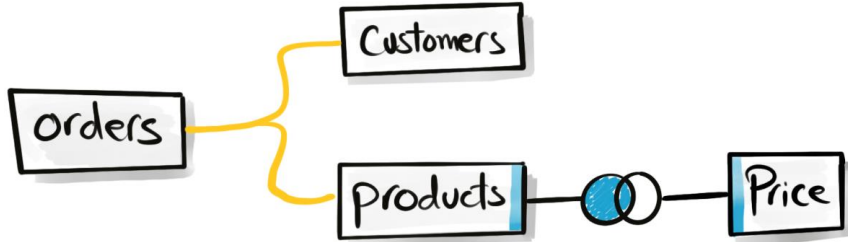

# Tableau Workbook Files

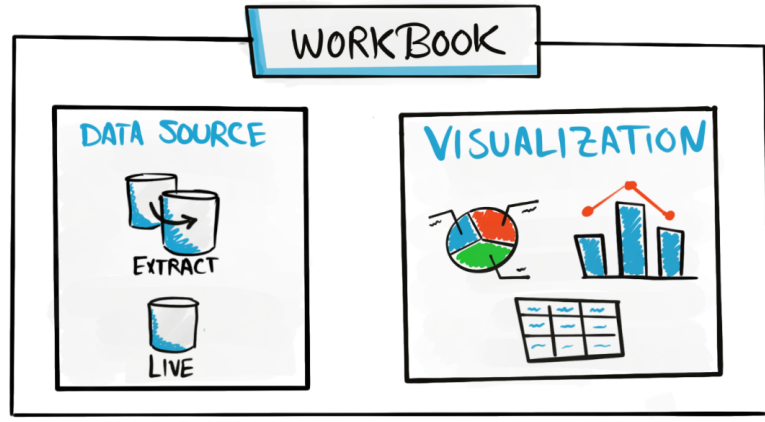

DATA

METADATA



ID	Prod	Price
1	A	20.5
2	D	8.99
3	F	
4		



```

<metadata class = 'column'>
  <name> Code </name>
  <type> Integer </type>
  <count> 631 </count>
</metadata>
  
```

SALES.TWB

## SOURCE

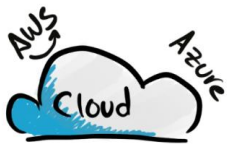

## DESKTOP

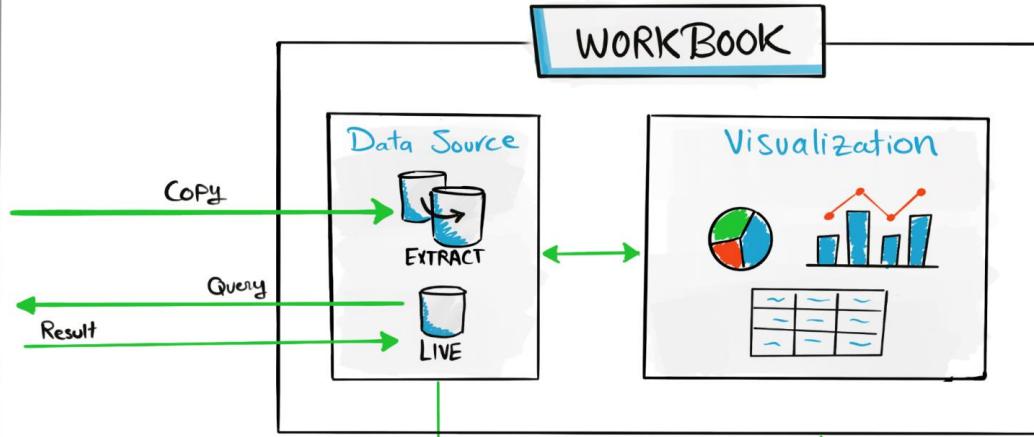

Publish Data Source

Publish Workbook

## SERVER

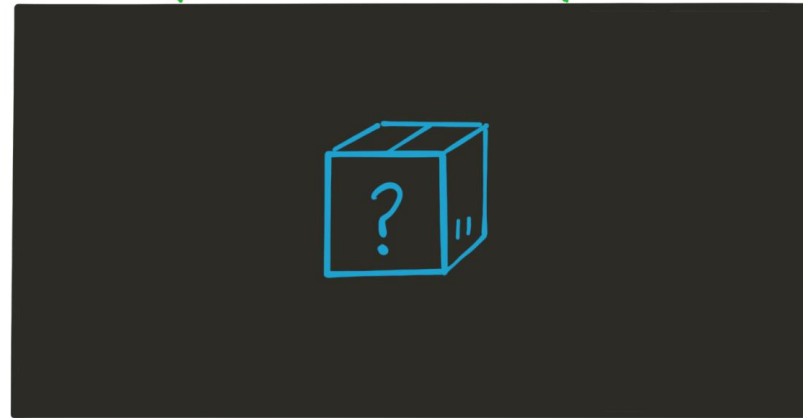

## CONSUMER

.TWBX



.HYPER .TDSX .TWBX  
.TDS .TWB

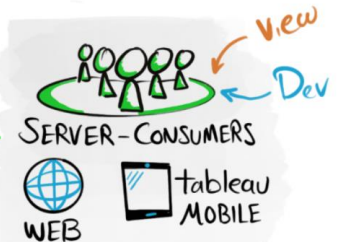

REPOSITORY



APPLICATION  
SERVER  
`</>`

FILE STORE



GATEWAY



Publish



tableau Desktop

WORKBOOK





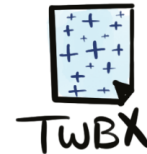
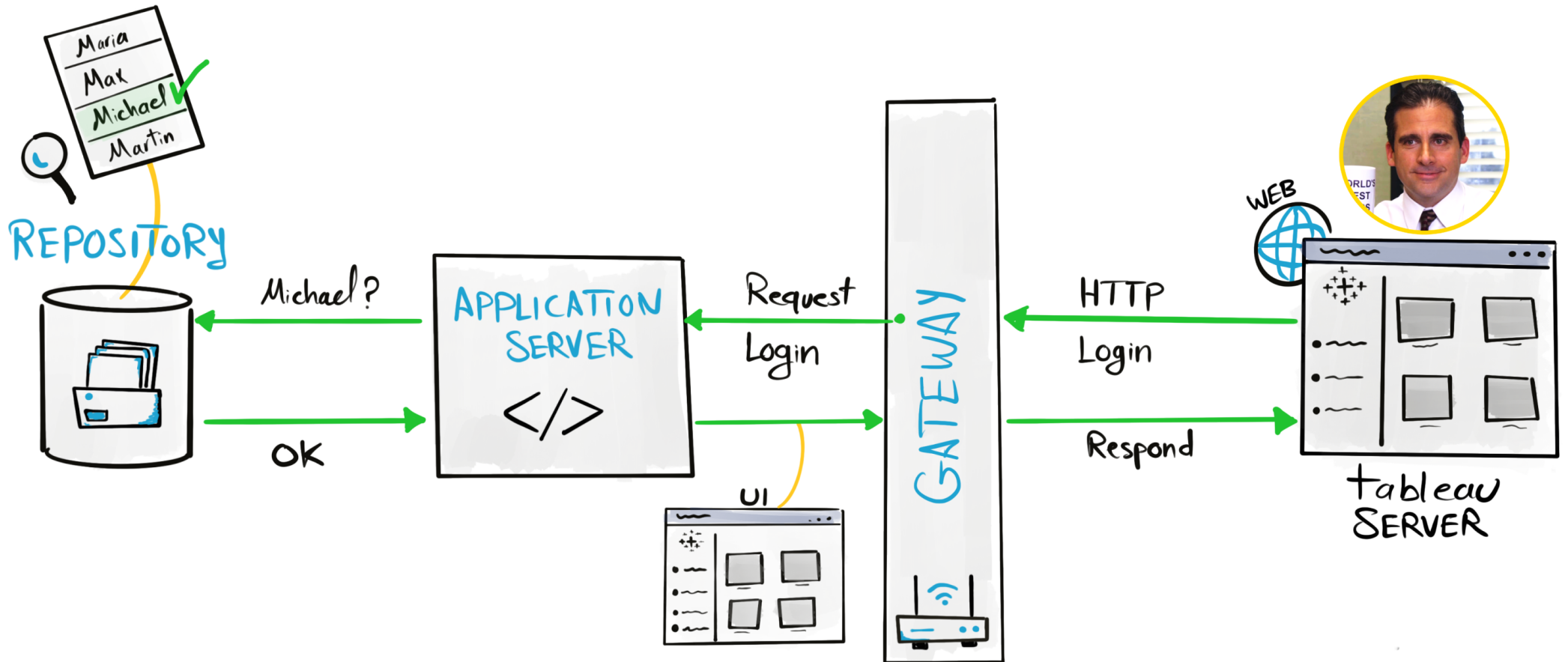

# VIZ Access Process

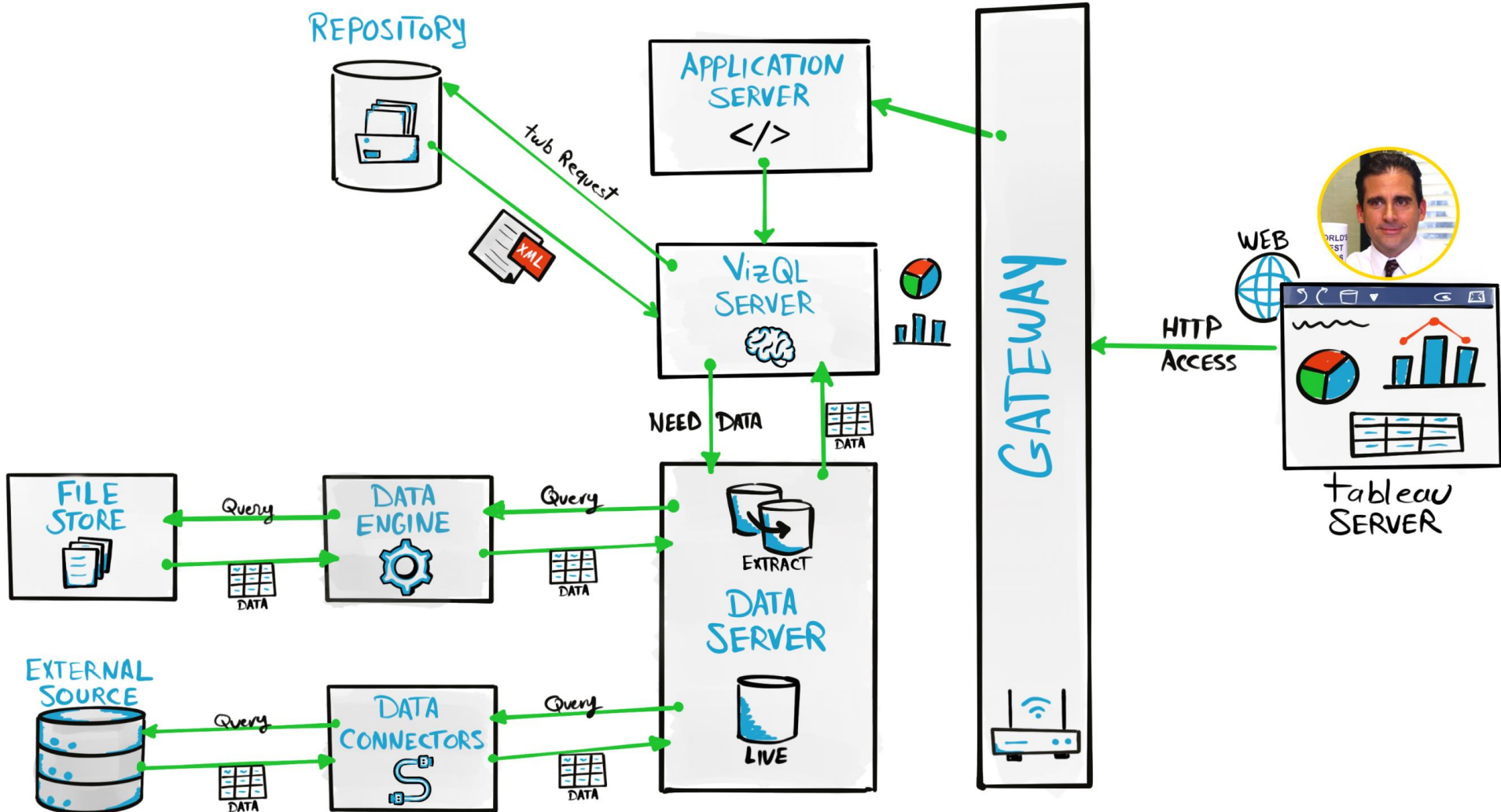

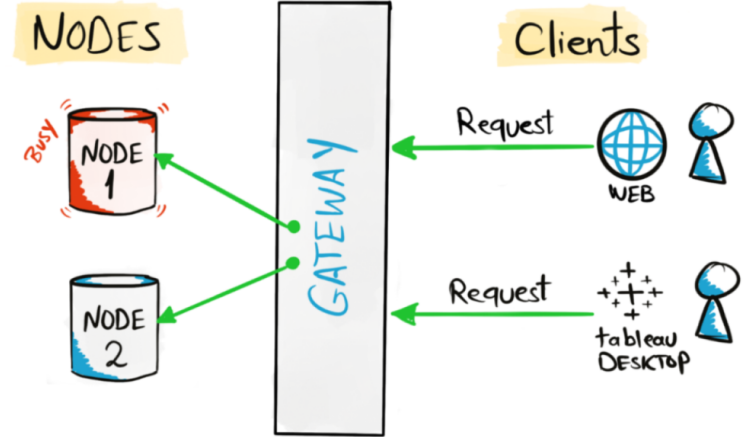
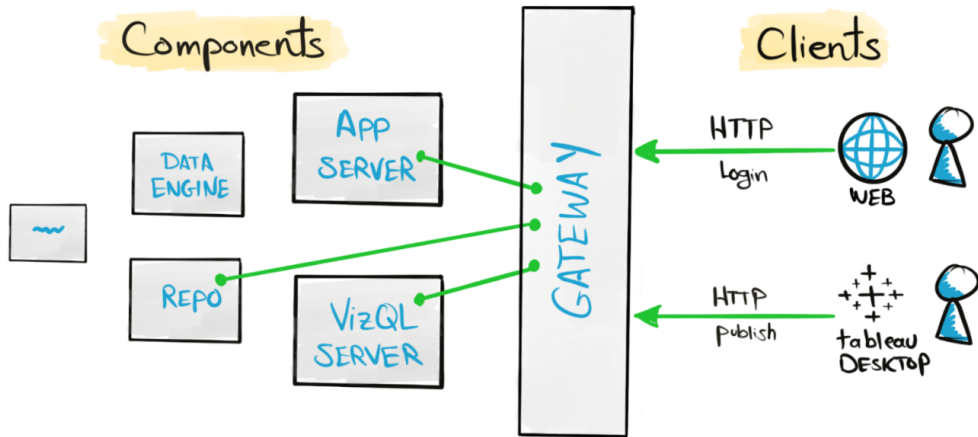
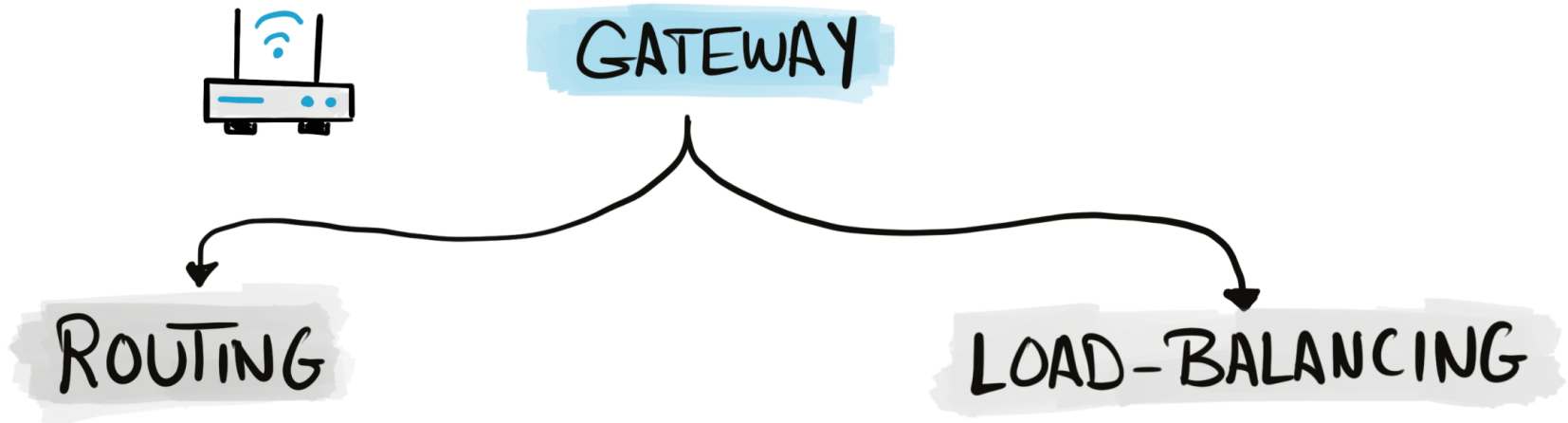

</>

# APPLICATION SERVER

## Authentication & Authorisation

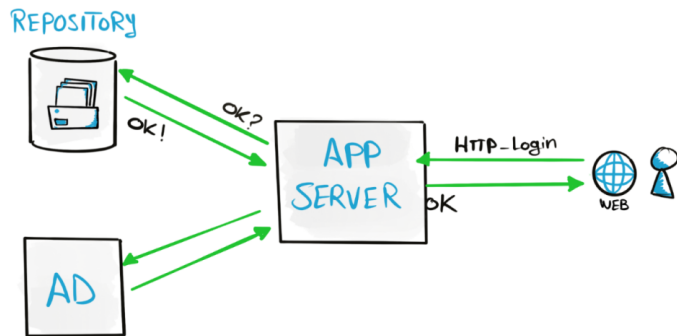

## Publishing

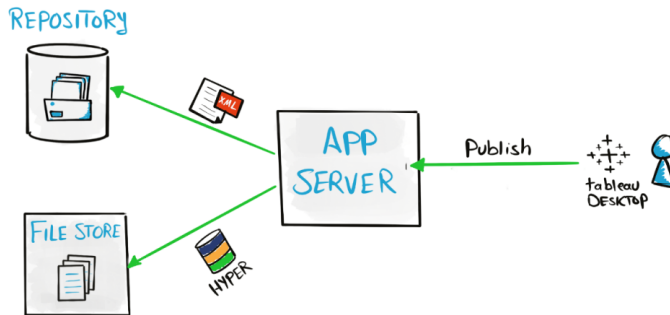

## UI Rendering

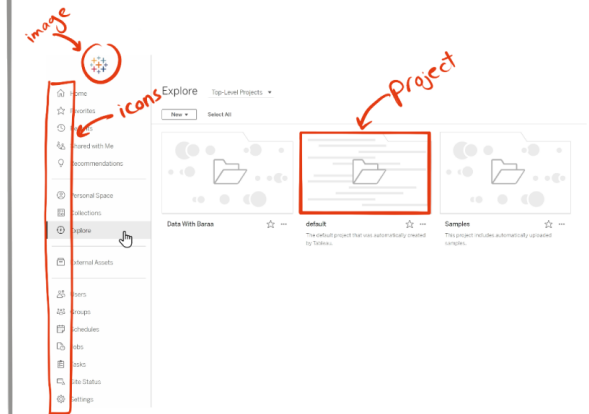



# VizQL SERVER

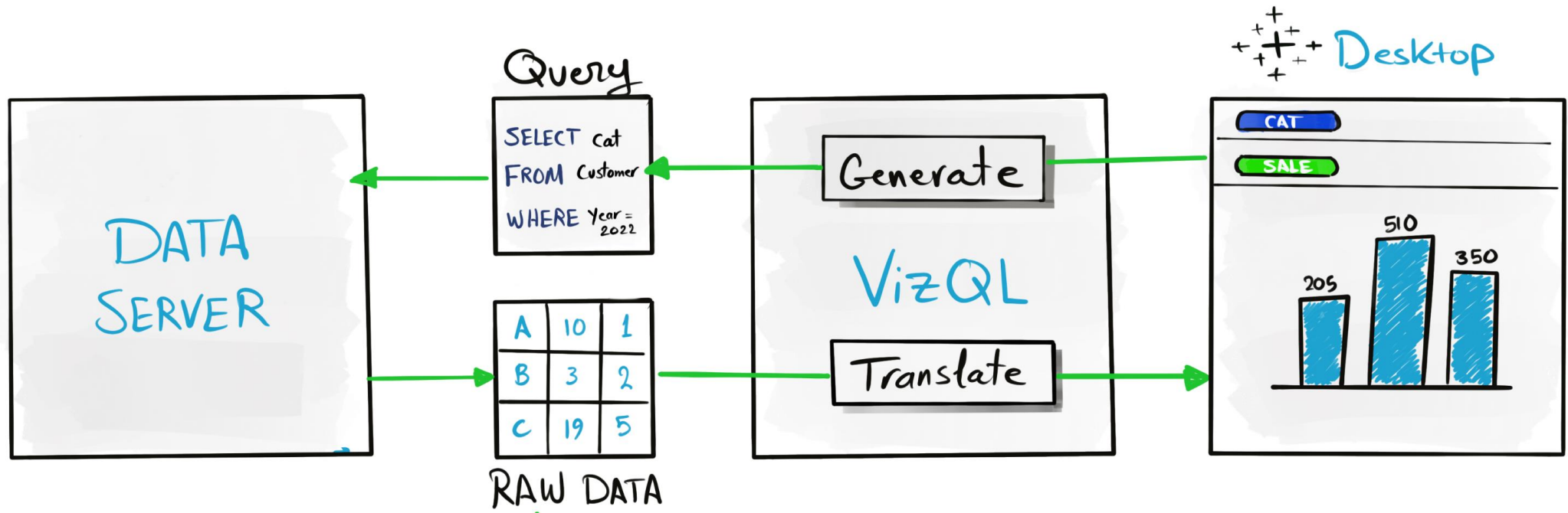



# DATA ENGINE

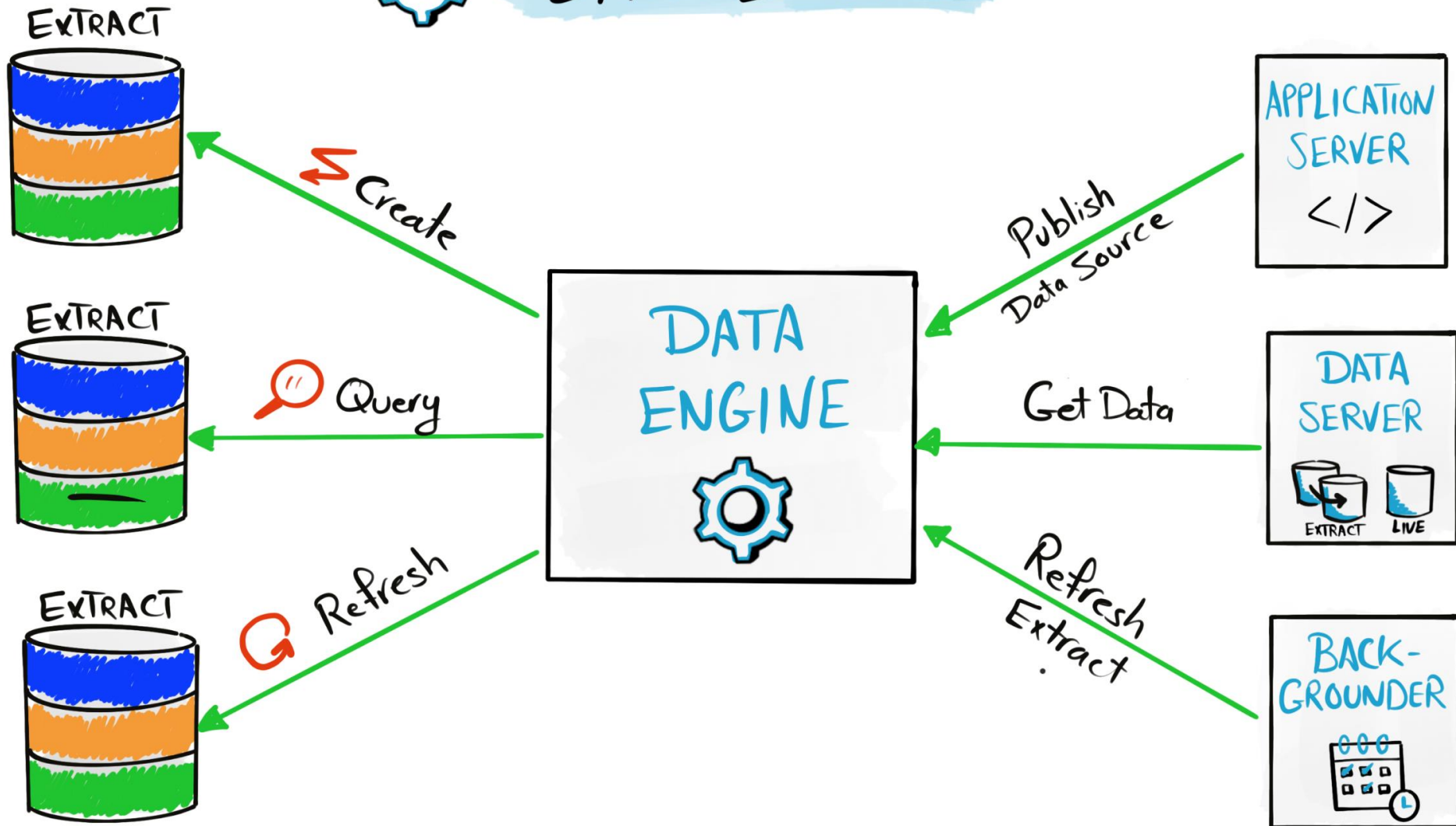

# DATA SERVER

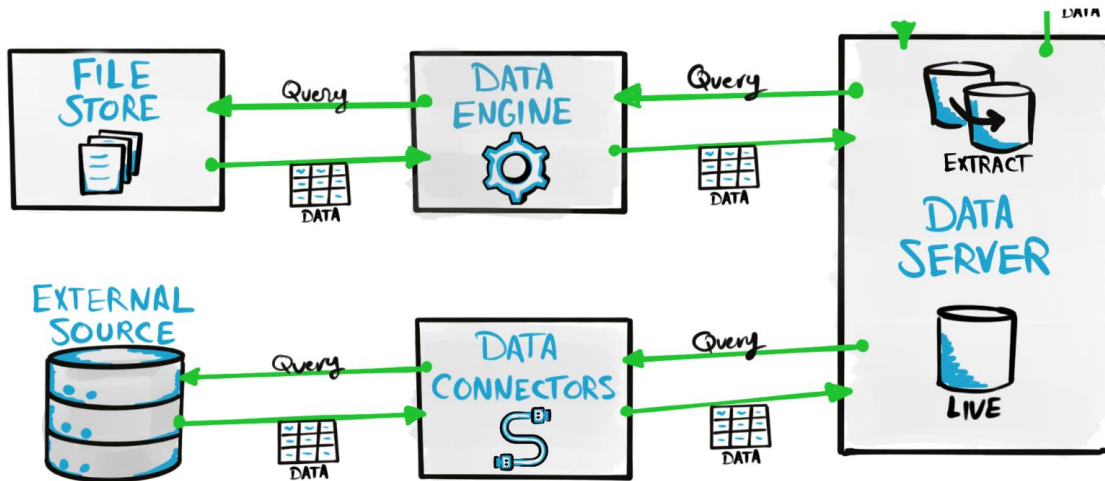

- Manages EXTRACT & LIVE dataSources
- Act as Proxy
- Enforces data Security
- Driver deployment



# REPOSITORY

## WORKBOOK DATA

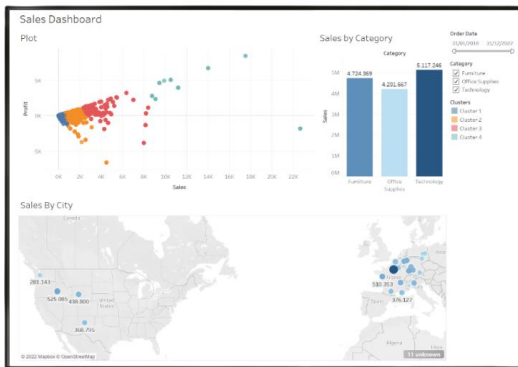

```

<metadata class = 'column'>
  <name> Code </name>
  <type> Integer </type>
  <count> 631 </count>
</metadata>

```

SALES.TWB

## USAGE DATA

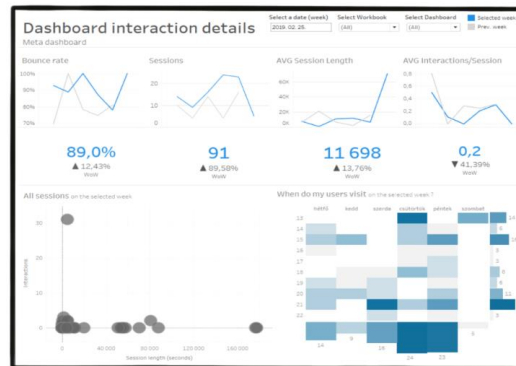

- Total active Users ?
- Total View Count ?
- Most used Data Sources

## SECURITY DATA

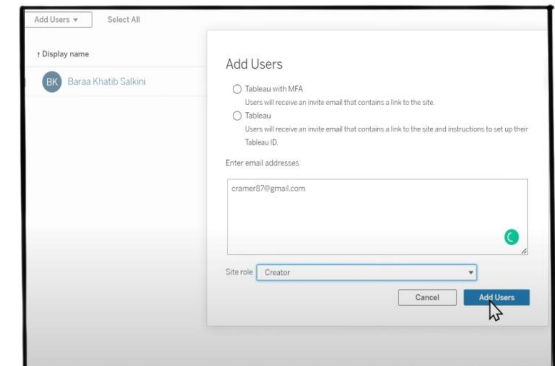

NAME	REPORT
John	Sales
Michael	Sales
Max	Finance



# REPOSITORY

## WORKBOOK DATA

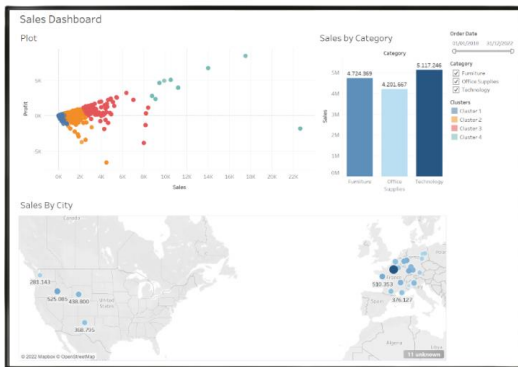

```

<metadata class = 'column'>
  <name> Code </name>
  <type> Integer </type>
  <count> 631 </count>
</metadata>

```

SALES.TWB

## USAGE DATA

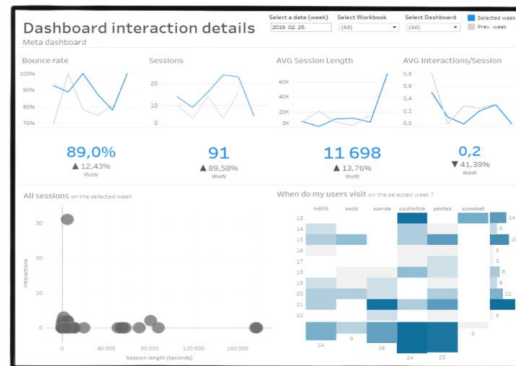

- Total active Users ?
- Total View Count ?
- Most used Data Sources

## SECURITY DATA

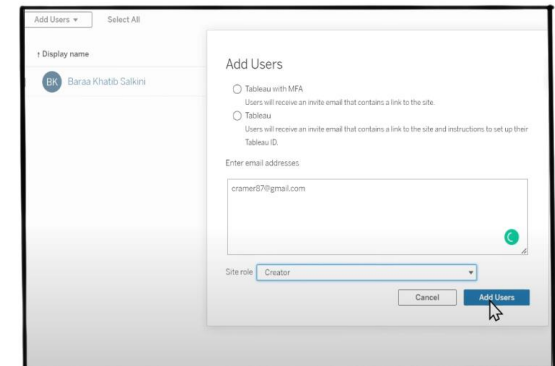

NAME	REPORT
John	Sales
Michael	Sales
Max	Finance



# Tableau Architecture

